

Retekess

Portable FM Transmitter

User Manual

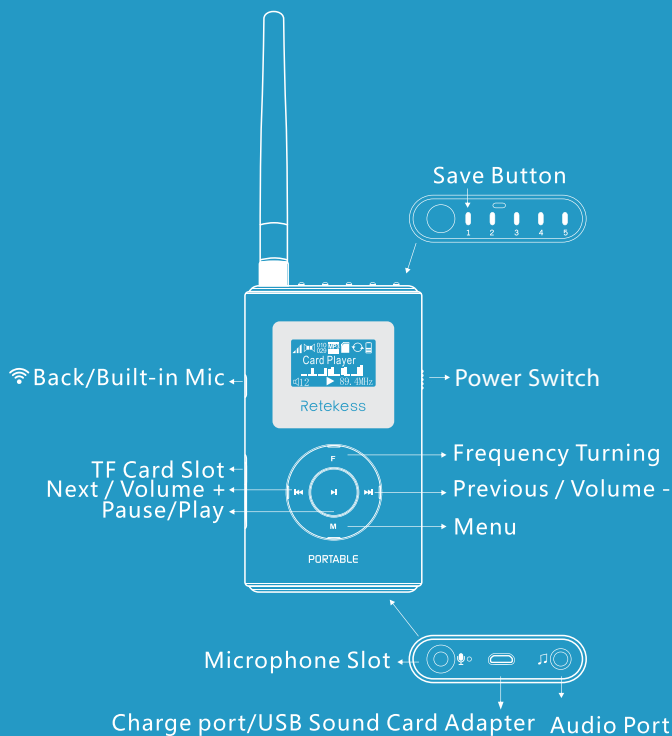

1. Power ON/OFF

【Power ON】

Slide power switch down, make the green part below of switch visible, the transmitter gets into work mode.

【Power OFF】

Slide power switch up, make the red part below of switch visible, the transmitter stops working.

2. Main Interface Operation

【Play/Pause】

In TF mode or computer sound adapter mode, short press **▶||** button can play or pause audio.

【Previous】

In TF mode or compute sound adapter mode, short press **◀◀** button to play previous video.

【Next】

In TF mode or compute sound adapter mode, short press **▶▶** button to play next video.

【Volume】

Long press **◀◀** button to decrease volume, Long press **▶▶** to increase volume.

【Start up built-in microphone】

Hold and press on **📶** button to turn on built-in microphone. When you stop pressing **📶** button, the microphone will shut off.

【Turn on screen/Return】

Short press **📶** button can light up the screen and back to the main interface.

3. FM Frequency Setting

【Frequency】

Short press **F** button continuously, until **1 Frequency** appears. Short press **◀◀** or **▶▶** button, the frequency will go forwards 100K each time; Long press **◀◀** or **▶▶** button, the frequency will go forwards 1MHz each time.

【RF Power】

Short press **F** button continuously, until **2 RF Power** appears. Short press **▶▶** button to increase power rate and short press **◀◀** button to decrease power rate. Attention: In small area usage, for example, in car, low power rate mode is recommended.

【Bui It in MIC】

Short press **F** button continuously, until **3 Built in MIC** appears. Short press **▶▶** or **◀◀** button to go to built in microphone setting mode.

- ◆ **【External MIC】** means turning off the built in microphone .
- ◆ **【MIC ON By Key】** means turning on built in microphone.
- ◆ **【MIC Always ON】** means the built in microphone is ready all the time.

1

【Sound Channel】

Short press **F** button continuously, until **4 Sound Channel** appears. Short press **◀◀** or **▶▶** button to set FM sound tracks.

【Pre-emphasis】

Short press **F** button continuously, until **5 Pre-emphasis** appears. Short press **◀◀** or **▶▶** button to set FM pre-emphasis time.

4. MP3 Setting

【MIC VOL】

Short press **M** button continuously, until **1 MIC VOL** appears. Short press **◀◀** button to increase mic volume. Short press **▶▶** to decrease mic volume.

【MIC ECHO】

Short press **M** button continuously, until **2 MIC ECHO** appears. Short press **◀◀** button to increase echo volume. Short press **▶▶** to decrease echo volume.

【MIC Delay】

Short press **M** button continuously, until **3 MIC delay** appears. Short press **◀◀** button to increase mic delay. Short press **▶▶** to decrease mic delay.

【EQ】

Short press **M** button continuously, until **4 EQ** appears. Short press **◀◀** or **▶▶** button can set sound effect for the whole kit.

【Repeat】

Short press **M** button continuously, until **5 Repeat** appears. Short press **◀◀** or **▶▶** button can set Mp3 cycle mode.

【BASS】

Short press **M** button continuously, until **6 BASS** appears. Short press **◀◀** or **▶▶** button can set BASS for the whole kit.

【TREB】

Short press **M** button continuously, until **7 TREB** appears. Short press **◀◀** or **▶▶** button can set tone for the whole kit.

【Language】

Short press **M** button continuously, until **8 Language** appears. Short press **◀◀** or **▶▶** button can set Language for the whole kit.

5. Frequency Saving and Use Saved Frequencies

Turn out your wanted frequency, then long press save button until frequency button flashes. Thus, this frequency is saved. When you want to switch to this frequency next time, you just need short press the save button to find it.

6. TF Card,Audio Input,USB Sound Card, Microphone

【TF Card Instalation】

Put TF card in card slot, follow up the **【Main Interface Operation】**

【Audio Input play】

Connect this item to an audio source device with a 3.5mm audio cable. Main interface will display the connector icon. Thus, the connection is finished.

【USB Sound Card Display】

Connect this item to a computer with a USB cable. Main interface will display a computer icon. Thus, the connection is finished.

【Tip:Audio source priority】

Audio Input > USB Sound Card > TF Card

【External Microphone】

Put the external microphone connector to the transmitter's microph main interface displays the microphone icon. It means the connection is successful.

【Tips:Microphone Priority】

External microphones > Built in microphone

The external microphone must be a 3-step condenser microphone.

7. Charge

The transmitter can be charged when it is connected to an USB power supply device by USB cable.

Tips : The item can be charged both in on and off mode.

8. CAUTIONS

- ◆ Do not turn on the transmitter when its antenna is not installed.
- ◆ Don not use the transmitter in explosive environment such as gas station and oil warehouse.
- ◆ Please follow local laws and regulation when using this transmitter.
- ◆ Repair of this transmitter can only operated by professional technicians.

9. Technology Parameters

| No. | Index | Data |
|-----|---------------------|---------------|
| 1 | Power | 5V、1000mA |
| 2 | Battery Capacity | 3.7V、2000mA |
| 3 | Battery Endurance | FT11 ≤ 10h |
| | | TR504 ≤ 8h |
| 4 | Work Currency | FT11 < 200mA |
| | | TR504 < 300mA |
| 5 | Frequency Stability | ± 10PPM |

2

3

| No. | Index | Data |
|-----|--------------------------|--------------------------|
| 6 | Frequency | 76~108Mhz |
| 7 | Frequency Step | 100KHz |
| 8 | Work Temperature | -10 C ~ 45 C |
| 9 | Output Impedance | 50Ω |
| 10 | RF Output Power Rate | FT11: 1mW~300mW |
| | | TR504: 10mW~600mW |
| 11 | Harmonic and Noise Wave | ≤ -30dB |
| 12 | TF Card Capacity | ≤64G |
| 13 | Audio Format | FLAC、 WAV、 PCM、 WMA、 MPS |
| 14 | Audio Distortion | 0.1% |
| 15 | Response Frequency | 30Hz ~ 15000Hz |
| 16 | Isolation | ≥ 40dB |
| 17 | Input Electric Potential | ≤ -15~15dVB |
| 18 | Frequency Offset | ± 75KHz |
| 19 | SNR. | ≥ 70dB |
| 20 | Item Size | 99*58*15mm |
| 21 | Item Weight | 76g |

10. Warnings



Before using this radio, read this guide which contains important operating instructions for safe usage and RF energy awareness and control for compliance with applicable standards and regulations.

Local Government Regulations

When the radios are used as a consequence of employment, the Local Government Regulations requires users to be fully aware of and able to control their exposure to meet occupational requirements. Exposure awareness can be facilitated by the use of a product label directing users to specific user awareness information. Your Reteless radio has a

4

and the ROHS Directive 2011/65/EU and the WEEE Directive 2012/19/EU
The full text of the EU declaration of conformity is available at the following internet address: www.tivdio.com

IC ID

This device complies with Industry Canada license-exempt RSS standard(s). Operation is subject to the following two conditions:

- (1) This device may not cause interference, and
- (2) This device must accept any interference, including interference that may cause undesired operation of the device.

In terms of measuring RF energy for compliance with these exposure guidelines, your radio generates measurable RF energy only while it is transmitting (during talking), not when it is receiving (listening) or in standby mode.

Avoid Choking Hazard



Small Parts. Not for children under 3 years.

Turn off your radio power in the following conditions:



- Turn off your radio before removing (installing) a battery or accessory or when charging battery.
- Turn off your radio when you are in a potentially hazardous environments: Near electrical blasting caps, in a blasting area, in explosive atmospheres (flammable gas, dust particles, metallic powders, grain powders, etc.).
- Turn off your radio while taking on fuel or while parked at gasoline service stations.

To avoid electromagnetic interference and/or compatibility conflicts

- Turn off your radio in any facility where posted notices instruct you to do so, hospitals or health care facilities (Pacemakers, Hearing Aids and Other Medical Devices) may be using equipment that is sensitive to external RF energy.
- Turn off your radio when on board an aircraft. Any use of a radio must be in accordance with applicable regulations per airline crew instructions.

Avoid Burns



Antennas

- Do not use any portable radio that has a damaged antenna. If a damaged antenna comes into contact with the skin when the radio is in use, a minor burn can result.

6

RF Exposure Product Label. Also, your user manual, or separate safety booklet includes information and operating instructions required to control your RF exposure and to satisfy compliance requirements.

Compliance with RF Exposure Standards (If appropriate, Reference to the actual product's Safety Marking)

Your Reteless radio is designed and tested to comply with a number of national and International standards and guidelines (listed below) for human exposure to radio frequency electro-magnetic energy.

FCC ID

The FCC ID means: This radio complies with the IEEE (FCC) and ICNIRP exposure limits for occupational/controlled RF exposure environments at operating duty factors of up to 50% talk-50% listen and is approved for occupational use only.

This device complies with Part 15 of the FCC Rules. Operation is subject to the following two conditions:

- (1) This device may not cause harmful interference, and
- (2) This device must accept any interference received, including interference that may cause undesired operation.

Warning: Changes or modifications not expressly approved by the party responsible for compliance could void the user's authority to operate the equipment.

NOTE:

This equipment has been tested and found to comply with the limits for a Class B digital device, pursuant to Part 15 of the FCC Rules. These limits are designed to provide reasonable protection against harmful interference in a residential installation. This equipment generates uses and can radiate radio frequency energy and, if not installed and used in accordance with the instructions, may cause harmful interference to radio communications. However, there is no guarantee that interference will not occur in a particular installation. If this equipment does cause harmful interference to radio or television reception, which can be determined by turning the equipment off and on, the user is encouraged to try to correct the interference by one or more of the following measures:

- ◆ Reorient or relocate the receiving antenna.
- ◆ Increase the separation between the equipment and receiver.
- ◆ Connect the equipment into an outlet on a circuit different from that to which the receiver is connected.
- ◆ Consult the dealer or an experienced radio/TV technician for help.



The CE marking means: Hereby, Henan Eshow Electronic Commerce Co.,Ltd. declares that the radio equipment type FT11 is in compliance with the RED Directive 2014/53/EU

5

Batteries (If appropriate)

- When the conductive material such as jewelry, keys or chains touch exposed terminals of the batteries, may complete an electrical circuit (short circuit the battery) and become hot to cause bodily injury such as burns. Exercise care in handling any battery, particularly when placing it inside a pocket, purse or other container with metal objects

Batteries (If appropriate)

- When the transceiver is used for long transmissions, the radiator and chassis will become hot.

Safety Operation



Forbid

- Do not use charger outdoors or in moist environments, use only in dry locations/conditions.
- Do not disassemble the charger, that may result in risk of electrical shock or fire.
- Do not operate the charger if it has been broken or damaged in any way.
- Do not place a portable radio in the area over an air bag or in the air bag deployment area. The radio may be propelled with great force and cause serious injury to occupants of the vehicle when the air bag inflates.

To reduce risk

- Pull by the plug rather than the cord when disconnecting the charger.
- Unplug the charger from the AC outlet before attempting any maintenance or cleaning.
- Contact Reteless for assistance regarding repairs and service.

EU Importer

Name: Germany Retevis Technology GmbH
Address: Uetzenacker 29,38176 wendeburg

7